

Multi-level packaging: Gloves

Logical, multi-level packaging to match your cleanroom donning protocol

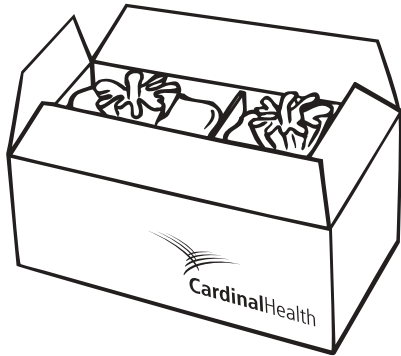

1 Outer shipping carton is securely sealed. Carton displays fully traceable lot number.



2 Cardinal Health multi-level interior packaging features a polyethylene carton liner for protection from dust and contamination, particularly if outer carton is discarded when gloves are placed in stock.



3 The “bag-within-a-bag” packaging helps to keep the contents free of foreign contaminants.

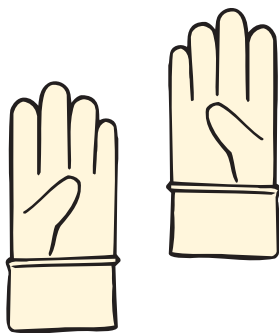

6 The sterile gloves can be aseptically donned.

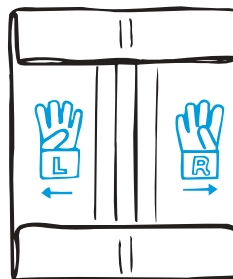

5 The inner wallet contains one pair of cuffed gloves.



4 Each pair of sterile gloves are completely heat-sealed and lot number traceable.

Stringent Quality Control

Cardinal Health cleanroom gloves are performance tested and are only released to the market after going through a variety of stringent tests. Each lot is fully traceable with the lot number indicated on all levels of packaging.